



U.S. GLOBAL RESOURCES

80 YEARS OF SERVICE TO A GROWING WORLD

ALL PLASTIC DISPLAY SYSTEM

PRODUCT CATALOG

US GLOBAL RESOURCES

80 YEARS OF SERVICE TO A GROWING WORLD

Toll-free: 1-888-334-1440

Texas: 830-755-4768

Email: usgr@usgr.com

Website: www.usgr.com

WHY CHOOSE US

Since 1981, we have provided customers across the nation with specialty display and fixture solutions made of heavy-duty plastic that are economical, functional, and distinctive. From greenhouse to grocery to big box chains, we serve an expansive range of industries.



**HDPE PLASTIC
WITH UV
INHIBITORS**



**NO TOOL
ASSEMBLY**



**INDOOR/
OUTDOOR USE**



UV RESISTANT



EASY TO CLEAN



**INTEGRATED
BRANDING**

INDUSTRIES WE SERVE

GREENHOUSE

GARDEN CENTERS

NURSERIES

RETAIL STORES

GROCERY STORES

WAREHOUSE

TABLE OF CONTENTS

2. ABOUT OUR DISPLAYS

4. PLATFORM RISERS

8. PLATFORM DISPLAYS

11. MULTI-LEVEL DISPLAYS

14. STEPPED DISPLAYS

20. ROUND DISPLAYS

24. SPECIALTY DISPLAYS

30. ACCESSORY PARTS

34. DESIGN SERVICE

35. DISPLAYS IN ACTION





Platform Risers

This collection features some of the most versatile retail displays for those looking for a quick and easy-to-use merchandising solution. Use them to define your space, guide customer traffic flow, or protect merchandise while maintaining a polished product presentation.

Our Platform Risers are the ideal multi-purpose display that will complement

your current merchandising program. Its modular design and capabilities allow you to stack them, move them, or change them up as your merchandising needs evolve.

Set the stage with a durable solution that will elevate the look of bulk stacks, promotional merchandise, and product feature without resorting to hideous wooden pallets.

STANDARD PLATFORMS

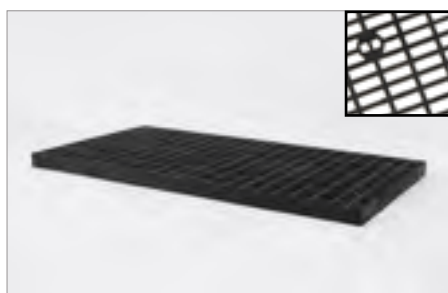

Grid Top Platform

This versatile platform solution can be used alone or stacked to your ideal height to get products off the floor. Ideal for narrow bulk stacks, lifestyle focal displays, or product showcases.

Product ID	Size (LxWxH)
SMB360316	36" x 16" x 3"
SMB660316	66" x 16" x 3"
SMB960316	96" x 16" x 3"
BMB360324	36" x 24" x 3"
BMB480324	48" x 24" x 3"
BMB660324	66" x 24" x 3"
BMB960324	96" x 24" x 3"
BMB360336	36" x 36" x 3"
BMB660336	66" x 36" x 3"
BMB960336	96" x 36" x 3"



Solid Top Platform

This platform features a consistent smooth surface for easy loading and unloading of heavy bulk merchandise or displaying product features.

Product ID	Size (LxWxH)
BMSB360324	36" x 24" x 3"
BMSB480324	48" x 24" x 3"
BMSB660324	66" x 24" x 3"
BMSB960324	96" x 24" x 3"
BMSB360336	36" x 36" x 3"
BMSB660336	66" x 36" x 3"
BMSB960336	96" x 36" x 3"



Stackable Solid Top Platform

Our unique D-window socket design provides a smooth surface with added versatility. Using our various collar accessories you can stack or add legs to create various platform and shelving configurations.

Product ID	Size (LxWxH)
BMBD360324	36" x 24" x 3"
BMBD480324	48" x 24" x 3"
BMBD660324	66" x 24" x 3"
BMBD960324	96" x 24" x 3"
BMBD360336	36" x 36" x 3"
BMBD660336	66" x 36" x 3"
BMBD960336	96" x 36" x 3"

RAISED PLATFORMS

Double Stack Platforms

These platforms add extra height, giving them a sturdy construction. Each configuration will meet food and beverage health codes while also providing additional protection for your products and the general public. The grid top surface allows dirt and debris to pass through easily, with clearance underneath for easier access when cleaning. The solid top provides a smooth surface perfect for creating lifestyle feature areas.



Solid Top Double Stack

Product ID	Size (LxWxH)
CBBS360624	36" x 24" x 6"
CBBS480624	48" x 24" x 6"
CBBS660624	66" x 24" x 6"
CBBS960624	96" x 24" x 6"
CBBS360636	36" x 36" x 6"
CBBS660636	66" x 36" x 6"
CBBS960636	96" x 36" x 6"



Grid Top Double Stack Riser

Product ID	Size (LxWxH)
BPB1360924	36" x 24" x 9"
BPB1480924	48" x 24" x 9"
BPB1660924	66" x 24" x 9"
BPB1960924	96" x 24" x 9"
BPB1360936	36" x 36" x 9"
BPB1660936	66" x 36" x 9"
BPB1960936	96" x 36" x 9"



Solid Top Double Stack Riser

Product ID	Size (LxWxH)
BPSRB36092402	36" x 24" x 9"
BPSRB48092402	48" x 24" x 9"
BPSRB66092402	66" x 24" x 9"
BPSRB96092402	96" x 24" x 9"
BPSRB36093602	36" x 36" x 9"
BPSRB66093602	66" x 36" x 9"
BPSRB96093602	96" x 36" x 9"

Solid Top Mobile Platform

This display is a floor-level merchandiser that's ready to move whenever you are. Whether you need to clean up a nasty spill, or relocate product quickly and easily throughout your store, simply unlock the caster wheels and you'll be on the move in no time.



Product ID	Size (LxWxH)
BCSB360901CB	36" x 24" x 9"
BCSB480901CB2	48" x 24" x 9"
BCSB660901CB	66" x 24" x 9"

Product ID	Size (LxWxH)
BCSB480901CB	48" x 36" x 9"
BCSB660901CB3	66" x 36" x 9"
BCSB960901CB3	96" x 36" x 9"



FEATURED PRODUCT



**Stock block H
Connector**
PAGE 31

Stock Block

The Stockblock is an interlocking platform “building block” that is 24-inches wide by 12-inches deep and 6-inches high. It can lock together vertically or be clipped together horizontally allowing you to stack, stagger, or set in any configuration that you can dream up. It’s ideal for use in aislesways, as a tiered end-cap, or for building a massive platform for the power aisle. Use alone or order a few dozen for every store!



Unlimited Configurations!

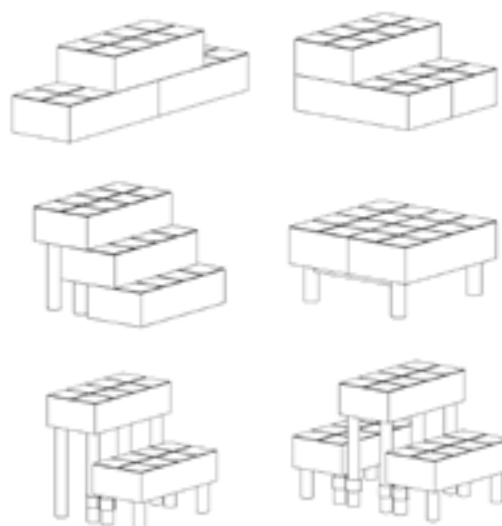

Product ID	Size (LxWxH)	Qty
BSBB240612	24" x 12" x 6"	1
BSBB2406122CX5	24" x 12" x 6"	5



Platform

Growers from Australia to Alaska have discovered the plant-friendly nature of our plastic benching systems. There are no metal parts to rust, no wooden parts to rot, and no place for insects to burrow or fungus to grow. Molded with the strongest commercially available UV-resistant recycled plastics, these benches will serve your needs for years to come.

Our Platform Benches are great for

elevating products off the floor in an organized and emphasized way. Standard configurations are available in heights of 12, 18, 24, and 30-inches, with other sizes available upon request.

A simple yet effective design makes these displays the ideal solution for grow facilities, temporary clearance, power aisles, seasonal, and outdoor storefront spaces.

BENCHING & TABLES

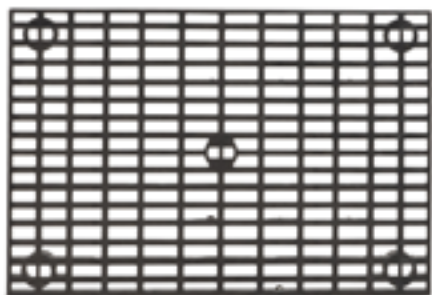

Grid Top Panel Display

The Grid Top Panel Display is one of the most versatile all-plastic benching system on the market. Molded with the strongest commercially available UV resistance, these benches will stay looking new and serve your needs for years to come. This display features a series of rectangular holes allowing debris and water to pass through easily, making it the ideal solution for growing and garden retail operations. With a wide variety of sizes and custom height options available, you'll never run out of ways to use this display.



16-inch Wide

Product ID	Size (LxWxH)
SMB361801S	36" x 16" x 18"
SMB362401S	36" x 16" x 24"
SMB363001S	36" x 16" x 30"
SMB661801S	66" x 16" x 18"
SMB662401S	66" x 16" x 24"
SMB663001S	66" x 16" x 30"
SMB961801S	96" x 16" x 18"
SMB962401S	96" x 16" x 24"
SMB963001S	96" x 16" x 30"



24-inch Wide

Product ID	Size (LxWxH)
BMB361801S	36" x 24" x 18"
BMB362401S	36" x 24" x 24"
BMB363001S	36" x 24" x 30"
BMB481801S	48" x 24" x 18"
BMB482401S	48" x 24" x 24"
BMB483001S	48" x 24" x 30"
BMB661801S	66" x 24" x 18"
BMB662401S	66" x 24" x 24"
BMB663001S	66" x 24" x 30"
BMB961801S	96" x 24" x 18"
BMB962401S	96" x 24" x 24"
BMB963001S	96" x 24" x 30"



36-inch Wide

Product ID	Size (LxWxH)
BMB361801S3	36" x 36" x 18"
BMB362401S3	36" x 36" x 24"
BMB363001S3	36" x 36" x 30"
BMB661801S3	66" x 36" x 18"
BMB662401S3	66" x 36" x 24"
BMB663001S3	66" x 36" x 30"
BMB961801S3	96" x 36" x 18"
BMB962401S3	96" x 36" x 24"
BMB963001S3	96" x 36" x 30"

Platform Level Displays



Solid Top Platform Bench Display

The Solid Top Platform Bench Display is designed to help meet more diverse merchandising and growing needs. These space-maximizing merchandisers lift up products so they're always in easy reach, while providing a smooth surface for moving products on, off, or around the display effortlessly. Use them for temporary tables in power-aisles and clearance sections, or as utility tables in growing environments. With a wide variety of sizes and custom height options available, you'll never run out of ways to use this display.



24-inch Wide

Product ID	Size (LxWxH)
BMSB361801S	36" x 24" x 18"
BMSB362401S	36" x 24" x 24"
BMSB363001S	36" x 24" x 30"
BMSB481801S	48" x 24" x 18"
BMSBB482401S	48" x 24" x 24"
BMS483001S	48" x 24" x 30"
BMSB661801S	66" x 24" x 18"
BMSB662401S	66" x 24" x 24"
BMSB663001S	66" x 24" x 30"
BMSB961801S	96" x 24" x 18"
BMSB962401S	96" x 24" x 24"
BMSB963001S	96" x 24" x 30"



36-inch Wide

Product ID	Size (LxWxH)
BMSB361801S3	36" x 36" x 18"
BMSB362401S3	36" x 36" x 24"
BMSB363001S3	36" x 36" x 30"
BMSB661801S3	66" x 36" x 18"
BMSB662401S3	66" x 36" x 24"
BMSB663001S3	66" x 36" x 30"
BMSB961801S3	96" x 36" x 18"
BMSB962401S3	96" x 36" x 24"
BMSB963001S3	96" x 36" x 30"



Sign Kit
PAGE 31



Multi-Shelving Displays

Our multi-functional shelving system features a simple yet sturdy design with versatility at its core. These modular multi-level units use a unique internal collar system that allows the user to switch up and use components to create benching, platform, or other multi-level configurations as their needs change.

This collection is ideal for retailers seeking a quick, yet versatile setup

for seasonal merchandising programs, backroom storage, product overflow, clearance, or holding oversized items.

Each configuration comes in grid-top or solid-top with various size and height options. Our grid-top features a flow-through pattern which makes it great for outdoor use, while the solid-top provides a smooth surface for easily loading and unloading products.

AISLE BENCH & MERCHANDISERS DISPLAY

Cube Merchandisers Display

Featuring a simple and sturdy design with versatility at its core, this multi-functional system is the perfect addition to central aisles or front-of-store. The lower level of this display is ideal for bulk or bagged goods while the top shelf can be used for cross merchandising lightweight items.



Grid Top

Product ID	Size (LxWxH)	Add'l Heights
SMB363602SC	36" x 16" x 36"	12" 18" 24" 30"
SMB663602SC	66" x 16" x 36"	
SMB963602SC	96" x 16" x 36"	
BMB363602SC	36" x 24" x 36"	
BMB483602SC	48" x 24" x 36"	
BMB663602SC	66" x 24" x 36"	
BMB963602SC	96" x 24" x 36"	
BMB363602S3C	36" x 36" x 36"	
BMB663602S3C	66" x 36" x 36"	
BMB963602S3C	96" x 36" x 36"	



Solid Top

Product ID	Size (LxWxH)	Add'l Heights
BMSB363602SC	36" x 24" x 36"	18" 24" 30"
BMSB483602SC	48" x 24" x 36"	
BMSB663602SC	66" x 24" x 36"	
BMSB963602SC	96" x 24" x 36"	
BMSB363602S3C	36" x 36" x 36"	
BMSB663602S3C	66" x 36" x 36"	
BMSB963602S3C	96" x 36" x 36"	

Use It Tip

Mix & Match DIY CONFIGURATIONS

Choose multiple heights to create your own tiered, pyramid, or focal displays.



Two Tier Bench Merchandiser

Our modular shelving display uses a unique collar system to give the ultimate range of versatility. This display is an ideal temporary solution for quick setup of seasonal merchandising programs, used for backroom storage, or as a long-term outdoor merchandising solution.



Two Level Grid Display

Product ID	Size (LxWxH)
BMB363602S	36" x 24" x 36"
BMB483602S	48" x 24" x 36"
BMB663602S	66" x 24" x 36"
BMB963602S	96" x 24" x 36"

Two Level Bench Merchandiser

Product ID	Size (LxWxH)
BMSB363602S	36" x 24" x 36"
BMSB663602S	66" x 24" x 36"
BMSB963602S	96" x 24" x 36"

Three Level Grid Display

This multi-level system provides an extra shelf of merchandising space and is perfect for packing out unruly items, bagged goods, and irregular shaped containers.



Three Level Grid Display

Product ID	Size (LxWxH)
BMB364803S	36" x 24" x 48"
BMB484803S	48" x 24" x 48"
BMB664803S	66" x 24" x 48"
BMB964803S	96" x 24" x 48"

Three Level Solid Display

Product ID	Size (LxWxH)
BMSB364803S	36" x 24" x 48"
BMSB664803S	66" x 24" x 48"
BMSB964803S	96" x 24" x 48"



Stepped Bench Displays

These displays are designed to display multiple tiers of merchandise for the ultimate product presentation. They come in a wide range of sizes and configurations, including single and double-sided.

The single-sided configurations will attract customers without sacrificing precious room. They fit perfectly in small, confined spaces and are well suited for

use as an end-cap with other Benchmaster displays, outdoors against the storefront's wall, or as a standalone merchandiser.

The double-sided displays will visually enhance your space and can be used to build out an entire space, or as an impulse display near fuel pumps and high-traffic aisleways. Both styles are available with caster bars, Waterbed™, and Plant Hanger Plus.

SINGLE-SIDED BENCH DISPLAYS

Our single-sided stepped displays are very popular for both indoor and outdoor use. Each configuration features unique characteristics to meet a range of merchandising applications.

- **Standard:** has a more refined appearance for displaying lightweight items
- **Heavy Duty:** features extra legs for a sturdy design that provides outstanding shelf stability
- **Extra Heavy Duty:** incorporates a metal bar for extreme stability for showcasing heavy products
- **Wide:** pairs functional design with extra depth on the lower shelf for maximum merchandising capacity



Standard Two Step

Product ID	Size (LxWxH)
SMB362402W	36" x 28" x 24"
SMB662402W	66" x 28" x 24"
SMB962402W	96" x 28" x 24"



Heavy Duty Two Step

Product ID	Size (LxWxH)
CWB362402	36" x 28" x 24"
CWB662402	66" x 28" x 24"
CWB962402	96" x 28" x 24"



Extra Heavy Duty Two Step

Product ID	Size (LxWxH)
CWB362402SB	36" x 28" x 24"
CWB662402SB	66" x 28" x 24"
CWB962402SB	96" x 28" x 24"



Two Step With Waterbed Tray

Product ID	Size (LxWxH)
SMB362402WWB	36" x 28" x 24"
SMB662402WWB	66" x 28" x 24"
SMB962402WWB	96" x 28" x 24"



Two Step Mobile

Product ID	Size (LxWxH)
SCB362402W	36" x 28" x 30"
BCB482402W	48" x 42" x 30"
SCB662402W	66" x 28" x 30"
SCB962402W	96" x 28" x 30"



Two Step Wide

Product ID	Size (LxWxH)
CWB362402L	36" x 36" x 24"
BMB482402W	48" x 42" x 24"
CWB662402L	66" x 36" x 24"
CWB962402L	96" x 36" x 24"

3 Tiered Bench Displays



Standard Three Step

Product ID	Size (LxWxH)
SMB363603W	36" x 39" x 36"
SMB663603W	66" x 39" x 36"
SMB963603W	96" x 39" x 36"



Heavy Duty Three Step

Product ID	Size (LxWxH)
CWB363603	36" x 39" x 36"
CWB663603	66" x 39" x 36"
CWB963603	96" x 39" x 36"



Extra Heavy Duty Three Step

Product ID	Size (LxWxH)
CWB363603SB	36" x 39" x 36"
CWB663603SB	66" x 39" x 36"
CWB963603SB	96" x 39" x 36"



Three Step With Caster

Product ID	Size (LxWxH)
SCB363603W	36" x 39" x 42"
SCB663603W	66" x 39" x 42"
SCB963603W	96" x 39" x 42"



Three Step With Waterbed Tray

Product ID	Size (LxWxH)
SMB363603WWB	36" x 39" x 36"
SMB663603WWB	66" x 39" x 36"
SMB963603WWB	96" x 39" x 36"



Three Step Waterbed + Caster

Product ID	Size (LxWxH)
SCB363603WWB	36" x 39" x 42"
SCB663603WWB	66" x 39" x 42"
SCB963603WWB	96" x 39" x 42"



Four Step Display Narrow

Product ID	Size (LxWxH)
SMB363604	36" x 28" x 36"
SMB663604	66" x 28" x 36"
SMB963604	96" x 28" x 36"



**Add-On
Accessory**

Retrofit Kits
PAGE 32

Transform Your Current Displays

Basket Hanger | Waterbed Tray | Tilt-Top



Turn
This...



...Into
This



...or
This



FEATURED PRODUCT



SMB967203W

Three Step With Hanging Basket

Combine versatility and function with our unique integrated hanging basket system. Featuring staggered hanging bars to allow all-out product visibility, this system is the most effective multi-purpose display you'll find. Our eight-foot units lets you hang up to 27 baskets with confidence.



Display Type	Product ID	Size (LxWxH)
	SMB367203W	36" x 39" x 84"
	SMB667203W	66" x 39" x 84"
	SMB967203W	96" x 39" x 84"
	SCB367203W	36" x 39" x 90"
	SCB667203W	66" x 39" x 90"
	SCB967203W	96" x 39" x 90"

Display Type	Product ID	Size (LxWxH)
	SMB367203WWB	36" x 39" x 84"
	SMB667203WWB	66" x 39" x 84"
	SMB967203WWB	96" x 39" x 84"
	SCB367203WWB	36" x 39" x 90"
	SCB667203WWB	66" x 39" x 90"
	SCB967203WWB	96" x 39" x 90"

DOUBLE-SIDED 3-STEP

TIERED DISPLAYS

Take advantage of vertical merchandising with our collection of double-sided stepped displays that showcase the full color and variety of products. Build out an entire space or use as a "show stopper" in high traffic areas. Each configuration features unique characteristics to meet a range of merchandising applications.

- **Standard:** has a more refined appearance for displaying lightweight items
- **Heavy Duty:** features extra legs for a sturdy design that provides outstanding shelf stability
- **Wide:** pairs functional design with extra depth on the middle shelf for maximum merchandising capacity



Standard Three Step

Product ID	Size (LxWxH)
SMB362403P	36" x 51" x 24"
SMB482403P	48" x 44" x 24"
SMB662403P	66" x 51" x 24"
SMB962403P	96" x 51" x 24"



Heavy Duty Three Step

Product ID	Size (LxWxH)
CPB362403	36" x 51" x 24"
CPB662403	66" x 51" x 24"
CPB962403	96" x 51" x 24"



Three Step with Casters

Product ID	Size (LxWxH)
SCB362403P	36" x 51" x 30"
SCB662403P	66" x 51" x 30"
SCB962403P	96" x 51" x 30"



Three Step With Waterbed Trays

Product ID	Size (LxWxH)
SMB362403PWB	36" x 51" x 24"
SMB662403PWB	66" x 51" x 24"
SMB962403PWB	96" x 51" x 24"



Three Step Wide Double Sided

Product ID	Size (LxWxH)
SMB362403P3	36" x 59" x 24"
BMB482403P	48" x 66" x 24"
SMB662403P3	66" x 59" x 24"
SMB962403P3	96" x 59" x 24"



Four Step Double Sided

Product ID	Size (LxWxH)
CMP3B63605	36" x 28" x 36"
CMPB663605	66" x 28" x 36"
CMPB963605	96" x 28" x 36"



Standard Five Step Bench

Product ID	Size (LxWxH)
SMB363605P	36" x 63" x 36"
SMB663605P	66" x 63" x 36"
SMB963605P	96" x 63" x 36"



Heavy Duty Five Step Bench

Product ID	Size (LxWxH)
CPB363605	36" x 63" x 36"
CPB663605	66" x 63" x 36"
CPB963605	96" x 63" x 36"



Five Step Bench With Caster

Product ID	Size (LxWxH)
SCB363605P	36" x 63" x 42"
SCB663605P	66" x 63" x 42"
SCB963605P	96" x 63" x 42"



Five Step With Waterbed Tray

Product ID	Size (LxWxH)
SMB363605PWB	36" x 63" x 36"
SMB663605PWB	66" x 63" x 36"
SMB963605PWB	96" x 63" x 36"



Five Step Wide Bench

Product ID	Size (LxWxH)
SMB363605P3	36" x 81" x 36"
SMB663605P3	66" x 81" x 36"
SMB963605P3	96" x 81" x 36"



Five Step PHP Bench

Product ID	Size (LxWxH)
SMB367205P	36" x 63" x 84"
SMB667205P	66" x 63" x 84"
SMB967205P	96" x 63" x 84"



Five Step With Caster

Product ID	Size (LxWxH)
SCB367205P	36" x 63" x 84"
SCB667205P	66" x 63" x 84"
SCB967205P	96" x 63" x 84"



Five Step With Waterbed Tray

Product ID	Size (LxWxH)
SMB367205PWB	36" x 63" x 84"
SMB667205PWB	66" x 63" x 84"
SMB967205PWB	96" x 63" x 84"





Round Displays

Our round displays are incredibly versatile and offer up to 360-degrees of display merchandising surface. We offer rounds in increments of 30, 36, 48, and 60 inches in diameter, making them perfect for most retail formats.

They are ideal for displaying everything from live goods to soft goods apparel to general merchandise.

The half round configurations are beneficial when used as an end cap. Each unit is designed to pair well with our various stepped and platform displays to create a consistent and polished appearance.

ROUND PLATFORMS



Half Round Platforms

Add a unique touch to your merchandising strategy for getting product off the ground. It's an ideal solution for creating floor-level spot-bulk stations up against the wall or incorporating softer lines when used in conjunction with other platform units.

Product ID	Size (LxWxH)
BRB300315F	30" x 15" x 3"
BRB360318F	36" x 18" x 3"
BRB480324F	48" x 24" x 3"
BRB600330F	60" x 30" x 3"



Round Platforms

This display is the ideal solution for enhancing your spot-bulk merchandising. These platform displays can be placed down aisleways to create interesting sight-lines or as an instant display for driving impulse buys.

Product ID	Size (LxWxH)
BRB300330F	30" x 30" x 3"
BRB360336F	36" x 36" x 3"
BRB480348F	48" x 48" x 3"
BRB600360F	60" x 60" x 3"

TIERED ROUNDS

Round Platform Riser

This single level display stands at 12-inches tall, providing a low profile for maintaining clear sightlines and 360-degree shoppability. Use this display to add a unique visual flair in aislesways or as overflow space for hot-selling items. From live goods to general merchandise to bulk items, this merchandiser is the perfect addition to any retail environment.



Product ID	Size (LxWxH)	Add'l Heights
BRB301201T	30" x 30" x 12"	6", 18"
BRB361201T	36" x 36" x 12"	6", 18", 24"
BRB481201T	48" x 48" x 12"	6", 18", 24"
BRB601201T	60" x 60" x 12"	-

Tiered Round Displays

This collection of displays are available in two, three, and four-level configurations. These merchandisers provide plenty of space for all types of products including live goods, seasonal, or food and beverage. Each display features a 48-inch or 60-inch diameter base with ample distance between shelves to maximize capacity without sacrificing floor space. Use as a show-stopper piece in aislesways, the decompression zone, or outdoors for a 360-degree shopping experience.



Two Tier Round

Product ID	Size (D/DxH)
BRB483602TR	48"/30" x 36"
BRB603602TR	60"/36" x 36"



Three Tier Round

Product ID	Size (D/D/DxH)
BRB484503T	48"/36"/30" x 45"
BRB604503T	60"/48"/36" x 45"



Four Tier Round

Product ID	Size (D/D/D/DxH)
BRB607304T	60"/48"/36"/30" x 73"

Half Round Platform Riser

Expand merchandising capacity without sacrificing on space with this Half Round Platform display. It can be used as a wall-merchandiser or in conjunction with our line of Platform Displays as an end cap. The curve of this display helps break up endless square-edges with a softer visual profile. This display is the perfect addition for creating cross-selling opportunities.



Product ID	Size (LxWxH)	Add'l Heights
BRB301201E	30" x 15" x 12"	24"
BRB361201E	36" x 18" x 12"	6", 18", 24"
BRB481201E	48" x 24" x 12"	18", 24" 30"
BRB601201E	60" x 30" x 12"	18", 24", 30"

Tiered Half Round Displays

This display type is available in two heights that are specifically designed to pair perfectly as an end cap to our Three Step and Five Step Pyramid Displays. This display will provide a finishing curve that draws your customers' eyes to the products on display and entices traffic to flow down the next main aisle.



Two Tier Half Round

Product ID	Size (L/LxH)
BRB482402E	48"/30" x 24"
BRB602402E	60"/36" x 24"

Three Tier Half Round

Product ID	Size (LxWxH)
BRB483602E	48"/30" x 36"
BRB603602E	60"/36" x 36"



**Perfect
Pair**

Pyramid Displays
PAGE 18



Specialty Displays

Unique merchandising challenges demand a unique display solution. Our collection of specialty displays are designed to tackle the most challenging merchandising with ease.

From dealing with corners to long handle merchandise to temporary impulse, you'll find just what you need to spotlight your product with our growing list of specialty displays.

Like many of our other displays, we've created focal points, nesting tables, long-handle tool carts, and table displays that will work in a wide array of retail business applications, both indoors and outdoors.

Can't find what you're looking for? Our kit-of-parts system allows us to develop semi-custom solutions that will meet your design challenge. Contact us to get started.

Long-Handle Merchandisers

Get your long-handle merchandise on the move and within sight of customers. There are up to 56 slots to store a variety of items ranging from fishing poles to tiki torches to yard tools. Place these displays in high traffic areas such as the storefront, vestibules, power aisles, or near the checkout for prompting impulse sales.



56-Slot Tool Rack

Product ID	Size (LxWxH)
BTRB363024	36" x 24" x 30"



48-Slot Tool Rack

Product ID	Size (LxWxH)
BTRB483024	48" x 24" x 30"



56-Slot Tool Cart

Product ID	Size (LxWxH)
BTCSB363724	36" x 24" x 37"

Nesting Tables

Each table set comes with a 48-inch and 36-inch long table that pairs perfectly together to create an elevated product presentation. We offer three variations to choose from with features such as extra shelf space and signage capabilities built right in. The addition of support bars make these tables a sturdy and durable merchandising solution. This display is ideal for use as a clearance, promotional, or bakery display.



Standard Nesting Tables

Product ID	Size (LxWxH)
BMSB483002NT	48" x 48" x 30"



Nesting Tables with Shelf

Product ID	Size (LxWxH)
BMSB483003NT	48" x 48" x 30"



Nesting Tables with Shelf & Signage Posts

Product ID	Size (LxWxH)
BMSB484203NTGC	48" x 48" x 42"



FEATURED PRODUCT



BMB962701TT

Tilt-Top Displays

This display provides superior product presentation through its unique frame that places items on a 15-degree slant. It's ideal for garden retailers who want a new and unique approach to showcasing the colorful and natural beauty of flora. The modularity of this display is unmatched, with its ability to easily transition from a tilt-top to



flat benching in minutes without tools or specialized labor. With a variety of heights to choose from, retailers can mix-and-match displays to create eye-catching configurations.

Height	Product ID	Size (LxWxH)
21-inch	BMB362101TT	36" × 24" × 21"
	BMB662101TT	66" × 24" × 21"
	BMB962101TT	96" × 24" × 21"
27-inch	BMB362701TT	36" × 24" × 27"
	BMB662701TT	66" × 24" × 27"
	BMB962701TT	96" × 24" × 27"

Height	Product ID	Size (LxWxH)
33-inch	BMB363301TT	36" × 24" × 33"
	BMB663301TT	66" × 24" × 33"
	BMB963301TT	96" × 24" × 33"
39-inch	BMB363901TT	36" × 24" × 39"
	BMB663901TT	66" × 24" × 39"
	BMB963901TT	96" × 24" × 39"

FOCAL DISPLAYS

Focal Display Collections

Our Focal Displays are collections of our top display pairings that can be configured together to create a single unified display perfect for product showcases. Each of our Focal Displays are curated to allow maximum versatility when merchandising programs change. Use each display alone or mix-and-match to make a configuration ideal for your merchandising needs.



Octagon Wall Display

Product ID	Size (LxWxH)
SMB9645100W	60" x 102" x 45"



Octagon Focal Display

Product ID	Size (LxWxH)
SMB9645140	102" x 102" x 45"



Hexagon Focal Display

Product ID	Size (LxWxH)
SMB843609X	84" x 84" x 36"



Five Step Plant Hanger Plus Island Display

Product ID	Size (LxWxH)
SMB967209PI	96" x 63" x 84"
SMB1267209PI	126" x 63" x 84"
SMB1567209PI	156" x 63" x 84"



Five Step Pyramid Island Display

Product ID	Size (LxWxH)
SMB923609PI	63" x 92" x 36"

CORNER DISPLAYS

Inside Corner Displays

These displays are uniquely designed to solve the merchandising struggle of wasted interior corner spaces in retail environments. With a variety of configuration and size options to choose from, there is sure to be a solution to fit your space requirements. These displays are the ideal solution for any retailer needing to maximize merchandising capacity while providing a comfortable place for customers to linger and shop without overwhelming them.



Inside Corner Octagon

Product ID	Size (LxWxH)
SMB964507OC	64" x 68" x 45"



Two Step Inside Corner

Product ID	Size (LxWxH)
SMB662404C	66" x 28" x 82"



Three Step Inside Corner

Product ID	Size (LxWxH)
SMB663604C	66" x 28" x 82"



Two Tier Quarter Round

Product ID	Size (R/RxH)
BRB302402Q	30"/18" x 24"



Extended Two Tier Quarter Round

Product ID	Size (R/RxH)
BRB303602QB	30"/18" x 36"



Three Tier Quarter Round

Product ID	Size (R/R/RxH)
BRB303603Q	30"/24"/18" x 36"

Outside Corner Displays

These displays are designed to fit around extruding corner walls of retail environments. Our display solutions will show off product with flair and invite customers to see what’s around the bend. We offer a variety of space efficient configurations that will enhance cross-merchandising strategies while eliminating what would traditionally be considered wasted space.



Two Tier Corner Round

Product ID	Size (D/DxH)
BRB482402Q	48”/30” x 24”
BRB602402Q	60”/36” x 24”



Three Tier Corner Round

Product ID	Size (D/D/DxH)
BRB603603Q	60”/48”/36” x 36”



Five Shelf Corner

Product ID	Size (LxWxH)
SMB403605C	40” x 40” x 36”

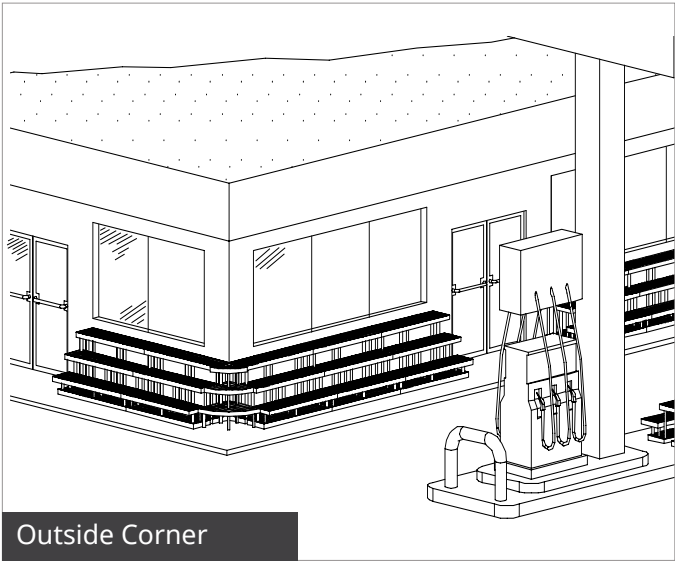
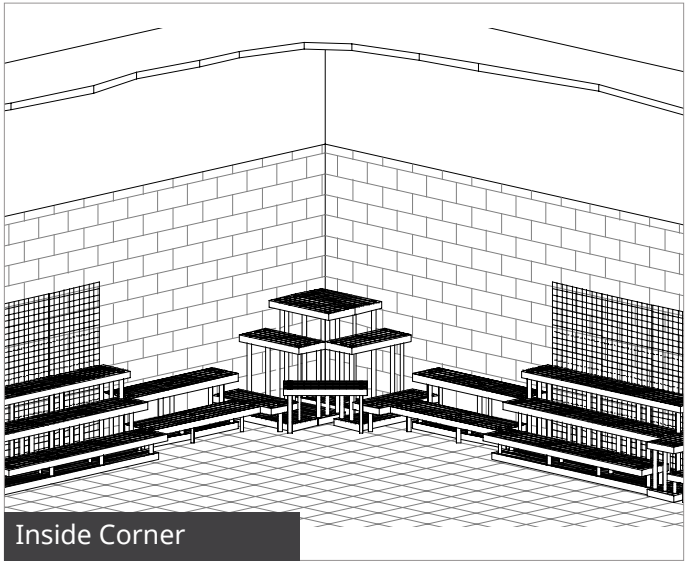



Accessory Parts

Choose from our accessories to add flair and functionality to your retail displays. From taller legs to customizable signs, we have the thoughtfully designed parts you need to apply finishing touches to your retail space, inside and out.

Looking for replacement parts? No problem. Simply contact us at **1-888-334-1440** or email us at **usgr@usgr.com** for more information.



Benchmaster™ Leg Posts

Leg posts specifically designed to be used with any of our panels.

Product ID	Size (LxD)
BMBLEG12	12" x 2.368"
BMBLEG18	18" x 2.368"
BMBLEG24	24" x 2.368"
BMBLEG30	30" x 2.368"
BMBLEG36	36" x 2.368"



Leg Post Clip

Connect the legs of two joining displays for extra stability.

Product ID	Size (LxWxH)
BLBC1	n/a



Benchmaster™ Collar

Use for stacking panels together.

Product ID	Size (LxWxH)
BMBSTACKER	2.5" x 2.5" x 3"



Leg Post Cap

Cap insert that can be used to add a finishing touch to leg posts.

Product ID	Size (LxWxH)
BMBPLC	2.25" x 2.25" x 1"



Sign Kit

A snap-on solution for integrating signage. It features an adjustable sign stand and a 7"H x 11"W sign plate.

Product ID	Size (LxWxH)
BSB110724	7" x 11" x 24"
BSB110724x5	7 x 11" x 24"



Stockblock™ H Connector

Connect multiple Stockblocks together for reduced movement and continual customer safety.

Product ID	Size (LxWxH)
SBB3001	n/a



Internal Leg Collar

Use for attaching legs to tops of panels.

Product ID	Size (LxWxH)
BMBCOLLARIN	2.5" x 2.5" x 3"



Graphic Clip

Customize a display with signage and branding. Snap it onto legs and secure graphics with velcro.

Product ID	Size (H)
BGBC15V1	1.5"



Bucket Ring Merchandiser

The perfect add-on accessory for expanding space for cross-sell opportunities onto your display.

Product ID	Size (LxWxH)
BMBRKB07	9" x 6" x 10"

RETROFIT KITS

How It Works

Each of our Retrofit Kits include everything you will need to transform your current display into some of our most popular configurations.

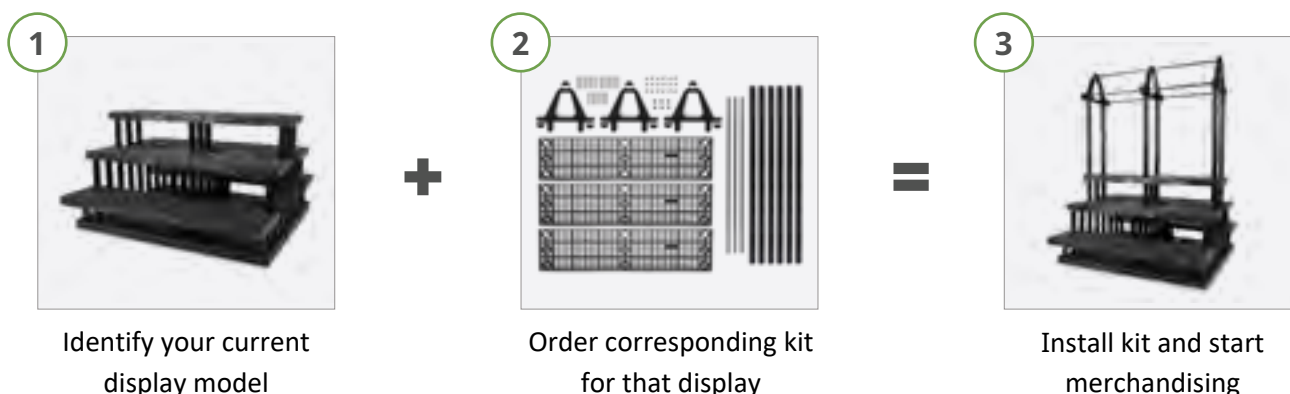

Plant Hanger Plus Retrofit Kit

This kit includes the entire Plant Hanger Plus system with pre-drilled panels to switch out and accommodate the longer leg posts without the guesswork.



Plant Hanger Plus DIY Kit

This kit includes the Plant Hanger Plus system without the pre-drilled panels. Instructions will be included for drilling out the correct sockets in your existing panels.

Product ID	Display Compatibility
PHBRF36WP	36"L 3-Step - SMB363603W
PHBRF66WP	66"L 3-Step - SMB663603W
PHBRF96WP	96"L 3-Step - SMB963603W
PHBRF36PP	36"L 5 Step - SMB363605P
PHBRF66PP	66"L 5 Step - SMB663605P
PHBRF96PP	96"L 5 Step - SMB963605P

Product ID	Display Compatibility
PHBRF36WNP	36"L 3-Step - SMB363603W
PHBRF66WNP	66"L 3-Step - SMB663603W
PHBRF96WNP	96"L 3-Step - SMB963603W
PHBRF36PNP	36"L 5 Step - SMB363605P
PHBRF66PNP	66"L 5 Step - SMB663605P
PHBRF96PNP	96"L 5 Step - SMB963605P



Waterbed™ Retrofit Kit

This kit allows you to integrate our plant hydration tray perfectly with your existing retail displays. Each kit is packaged to accommodate the configuration and length of your current display and will include all of the components you need to quickly update your display. The pressure-activated capillary mat allows plants to wick water from underneath to keep them hydrated.

Product ID	Display Compatability
SMB362402WWBRF	36" L 2 Step - SMB362402W
SMB662402WWBRF	66" L 2 Step - SMB662402W
SMB962402WWBRF	96" L 2 Step - SMB962402W
SMB363603WWBRF	36" L 3 Step - SMB363603W
SMB663603WWBRF	66" L 3 Step - SMB663603W
SMB963603WWBRF	96" L 3 Step - SMB963603W
SMB367203WWBRF	66" L 3 Step PHP - SMB367203W
SMB667203WWBRF	66" L 3 Step PHP - SMB667203W
SMB967203WWBRF	96" L 3 Step PHP - SMB967203W
SMB362403PWBRF	36" L 3 Step Pym - SMB362403P
SMB662403PWBRF	66" L 3 Step Pym - SMB662403P
SMB962403PWBRF	96" L 3 Step Pym - SMB962403P
SMB363605PWBRF	36" L 5 Step Pym - SMB363605P
SMB663605PWBRF	66" L 5 Step Pym - SMB663605P
SMB963605PWBRF	96" L 5 Step Pym - SMB963605P
SMB367205PWBRF	36" L 5 Step PHP - SMB367205P
SMB667205PWBRF	66" L 5 Step PHP - SMB367205P
SMB967205PWBRF	96" L 5 Step PHP - SMB367205P



Tilt-Top Retrofit Kit (under 12"H)

This kit easily integrates with most 2-foot wide Benchmaster™ panels with leg lengths shorter than 12-inches. When installed it will create the freestanding configuration of our Tilt-Top Display System.

Product ID	Display Compatability
MBTILTKIT36	BMB360324 + BMBLEG12
MBTILTKIT66	BMB660324 + BMBLEG12
MBTILTKIT96	BMB960324 + BMBLEG12

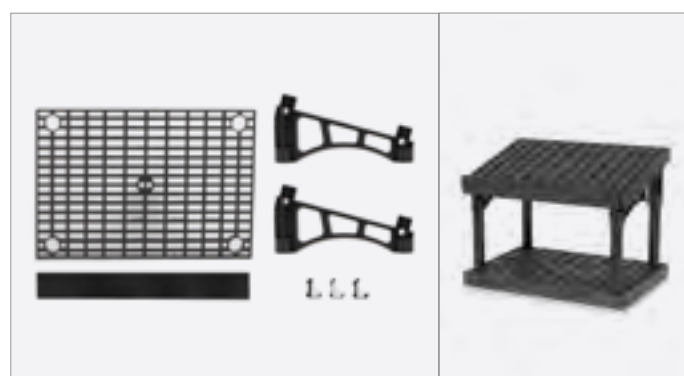

Tilt-Top Retrofit Kit (over 12"H)

This kit easily integrates with most 2-foot wide Benchmaster™ panels with leg lengths taller than 12-inches. When installed it will create the Tilt-Top Display System with base panel.

Product ID	Display Compatability
MBTILTKIT36P	BMB361801S, BMB362401S, BMB363001S
MBTILTKIT66P	BMB661801S, BMB662401S, BMB663001S
MBTILTKIT96P	BMB961801S, BMB962401S, BMB963001S

Get Help Planning Your Space

USGR understand that your retail display goals are specific and important. To meet those goals, we offer a complimentary layout and design service using our three step process.

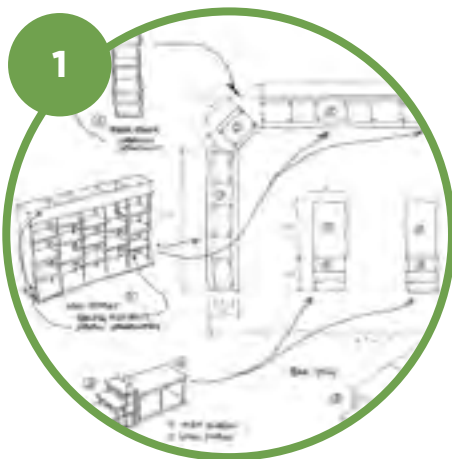

Identify Opportunity

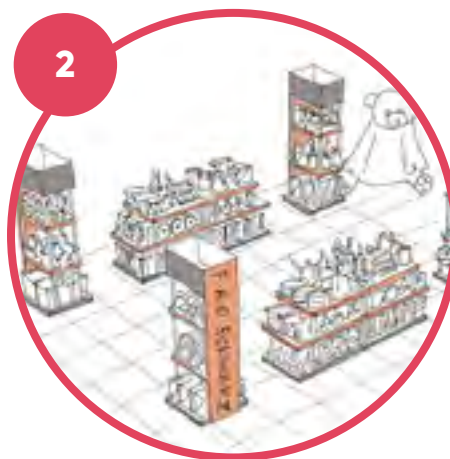

Design Space



Implement Solution

Together, We'll Get it Right

When you work with **US GLOBAL RESOURCES** you're our top priority. From the moment you contact us to the delivery of your new display, our team will make you and your store the center of our attention.

We'll collaborate with you to tailor our solutions to your needs, ensuring that you're happy with your displays and confident that they'll help you create a wonderful experience for your customers.

📞 888-334-1440 ✉️ usgr@usgr.com



HEAVY - DUTY BENCHES

Made of high-density polyethylene (HDPE) with UV inhibitors built into them, these display and growing benches will resist fading and will not crack in freezing temperatures. Tops are 2 5/8 inches thick so they can handle 35 lbs. per sq. ft.





ALL PLASTIC DISPLAY SYSTEM



U.S. GLOBAL RESOURCES

80 YEARS OF SERVICE TO A GROWING WORLD

U.S., CANADA & INTERNATIONAL SALES

Toll-free: 1-888-334-1440

Texas: 830-755-4768

Email: usgr@usgr.com

Website: www.usgr.com

